

The Florida Senate
COMMITTEE MEETING EXPANDED AGENDA

EDUCATION
Senator Gruters, Chair
Senator Jones, Vice Chair

MEETING DATE: Tuesday, October 12, 2021
TIME: 9:00—11:30 a.m.
PLACE: *Pat Thomas Committee Room, 412 Knott Building*

MEMBERS: Senator Gruters, Chair; Senator Jones, Vice Chair; Senators Berman, Bradley, Broxson, Diaz, Hutson, Passidomo, Polsky, and Thurston

TAB	BILL NO. and INTRODUCER	BILL DESCRIPTION and SENATE COMMITTEE ACTIONS	COMMITTEE ACTION
	Panel on Higher Education: Meeting the State's Education, Innovation, and Workforce Needs		
	Florida College System		
	Kathy Hebda, Chancellor, Florida College System		
	Angela Falconetti, President, Polk State College		
	Madeline Pumariega, President, Miami Dade College		
	Devin Stephenson, President, Northwest Florida State College		
	Tonjua Williams, President, St. Petersburg State College		
	State University System		
	Marshall Criser III, Chancellor, State University System		
	Randy Avent, President, Florida Polytechnic University		
	Alexander Cartwright, President, University of Central Florida		
	Pamela Chally, President, University of North Florida		
	Mike Martin, President, Florida Gulf Coast University		
	Other Related Meeting Documents		



FLORIDA: #1 IN HIGHER EDUCATION

Kathy Hebda, Chancellor
Florida College System



www.FLDOE.org

FLORIDA COLLEGE SYSTEM (FCS) PURPOSE AND MISSION

Florida College System

- ❑ **Article IX S.8 (a) PURPOSES.** In order to achieve excellence and to provide access to undergraduate education to the students of this state; to originate articulated pathways to a baccalaureate degree; to ensure superior commitment to teaching and learning; and to respond quickly and efficiently to meet the demand of communities by aligning certificate and degree programs with local and regional workforce needs.
- ❑ **1001.60, F.S. (1) PURPOSES.—** In order to maximize open access for students, respond to community needs for postsecondary academic education and career degree education, and provide associate and baccalaureate degrees that will best meet the state's employment needs.
- ❑ **1004.65, F.S.** As open-access institutions, serve all who can benefit, ...while emphasizing the achievement of social and educational equity so that all can be prepared for full participation in society.
- ❑ **1007.33, F.S. (2)** FCS institutions must continue to provide outreach to underserved populations.

Career and Technical Education

- ▼ **1004.92, F.S. (1)** The purpose of career education is to enable students who complete career programs to attain and sustain employment and realize economic self-sufficiency.
- ▼ School boards and Florida College System institution boards of trustees are accountable.

FCS OVERVIEW 2019-2020



28	Colleges
715,044	Students
113,212	Degrees/Certificates Awarded
63%	Part-time Enrollment
60%	Minority Enrollment
62%	Female Enrollment

FCS NATIONAL RECOGNITIONS AND AWARDS

#1 State in the Nation for Higher Education 2017, 2018, 2019, and 2021 – US News & World Report



Every year since its inception in 2011, FCS institutions have either won the Aspen Prize for Community College Excellence or earned recognition as a finalist or finalist with distinction.



Five FCS institutions are certified by the National Centers of Academic Excellence in Cybersecurity (NCAE-C) program: **Florida State College at Jacksonville, St. Petersburg College, Indian River State College, Daytona State College and Valencia College.**



Rankings from U.S. News & World Report also place **Seminole State College** and **St. Petersburg College** in the top 25 categories.

Each year FCS institutions are rated highly in various categories. In 2021, **North Florida College** was recognized for the 6th year as a great college to work for across five categories.



STATEWIDE ACCOMPLISHMENTS 2020 - 2021

Award Type	2020-21 Completions
Associate in Arts Degrees	60,457
Associate in Science (+AAS) Degrees	16,188
Certificates	40,236
Baccalaureate Degrees	11,170

- In 2020-21, FCS students completed 37,904 rapid credentials (short-term workforce degrees/certificates), up from 35,340 in 2018-19.
- In 2020-2021, FCS students completed 17,477 programs in allied health care (upper and lower division), up from 16,556 in 2018-29.

FCS STUDENT COST

The cost to FCS students has remained stable and very affordable.

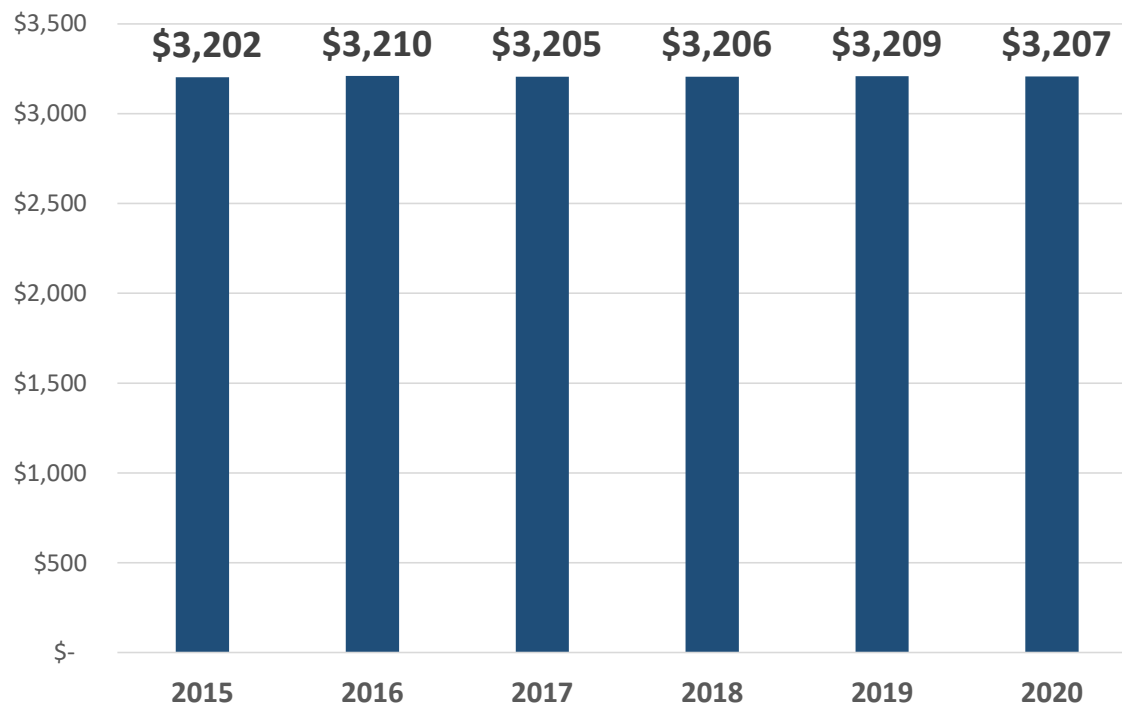

FCS Academic Year (30 hours) Tuition and Fees, weighted mean
Source: FCS Fact Book 2016-2020

FCS STUDENTS PREPARE TO WORK

Tallahassee Community College developed the oyster aquaculture certificate program as a sustainable alternative to wild oyster harvesting in response to the depleting level of oysters in the waters of Wakulla, Franklin and Gulf Counties.



Water Resources Management programs are designed to advance students with an interest in the environmental sciences into the field of water resources and conservation.



The College of the Florida Keys is the only FCS institution that is a partner with National Oceanic & Atmospheric Administration and the National Marine Sanctuaries working to solve Florida's coral reef disease.

Recently, Eastern Florida State College was designated as the latest national Advanced Composites Learning Center to train technicians in support of the Pentagon and Space Coast high-tech initiatives.



Eastern Florida
STATE COLLEGE

FCS INSTITUTIONS WORK TO SERVE THEIR COMMUNITIES



Broward College offers FREE educational opportunities, workforce training, and support services with the goal to help students get the training needed to find a good job, make more money and get the **skills needed to thrive** in the workforce.

Indian River State College's Project STAGE (Students Transitioning to Academics and Gainful Employment) program provides students with unique abilities a **well-rounded, fully inclusive**, modified college experience while they gain the skills needed to transition to independent adult roles and into the workplace.



Santa Fe College's 12-year partnership with Alachua Habitat for Humanity facilitates training of construction professionals and assists in Alachua Habitat's mission to provide affordable housing in our community. Home construction at the college gives the students hands-on experience as part of the established curriculum.

FCS GRADUATES' EMPLOYMENT AND CONTINUING EDUCATION

Degree	Percent Employed	Percent in Continuing Education	Percent Employed or Continuing Education
Associate in Science	80%	37%	81%
Career Certificates	81%	23%	82%
College Credit Certificates	74%	60%	74%
Applied Technology Diploma	79%	52%	80%
Advanced Technical Certificate	82%	22%	79%
Associate in Applied Science	74%	15%	88%
Associate in Arts	66%	70%	90%
Baccalaureate	79%	8%	81%

[2018-19 Completers in Fall 2019](#)

[Source: FETPIP Annual Outcomes Report](#)

ARTICULATION

- In fall 2020, approximately 83,000 FCS students comprised 41% of headcount enrollment in the State University System (SUS).
 - Over 69,000 FCS AA completers
 - Over 2,300 FCS AS completers
 - Over 10,700 other FCS transfers
- By 2020, 51% of AA graduates from 2018 had transferred into the SUS. Sixty-seven (67) percent of AA graduates had transferred into the SUS, Independent Colleges and Universities of Florida (ICUF) or FCS combined.
- Since 2019, the FCS has entered into over 100 targeted 2+2 agreements with SUS and other Florida colleges and universities.
- In 2021 the FCS and SUS signed an MOU to implement new reverse transfer policies and procedures.

DUAL ENROLLMENT

The FCS enrolls over 76,894 Dual Enrollment students throughout Florida.

- For the 2020-21 Academic Year:
 - Secondary students enrolled in 303,281 college credit courses.
 - 318 secondary students enrolled in 1,431 clock-hour courses.
 - Over 2,000 students earned their AA by high school graduation.

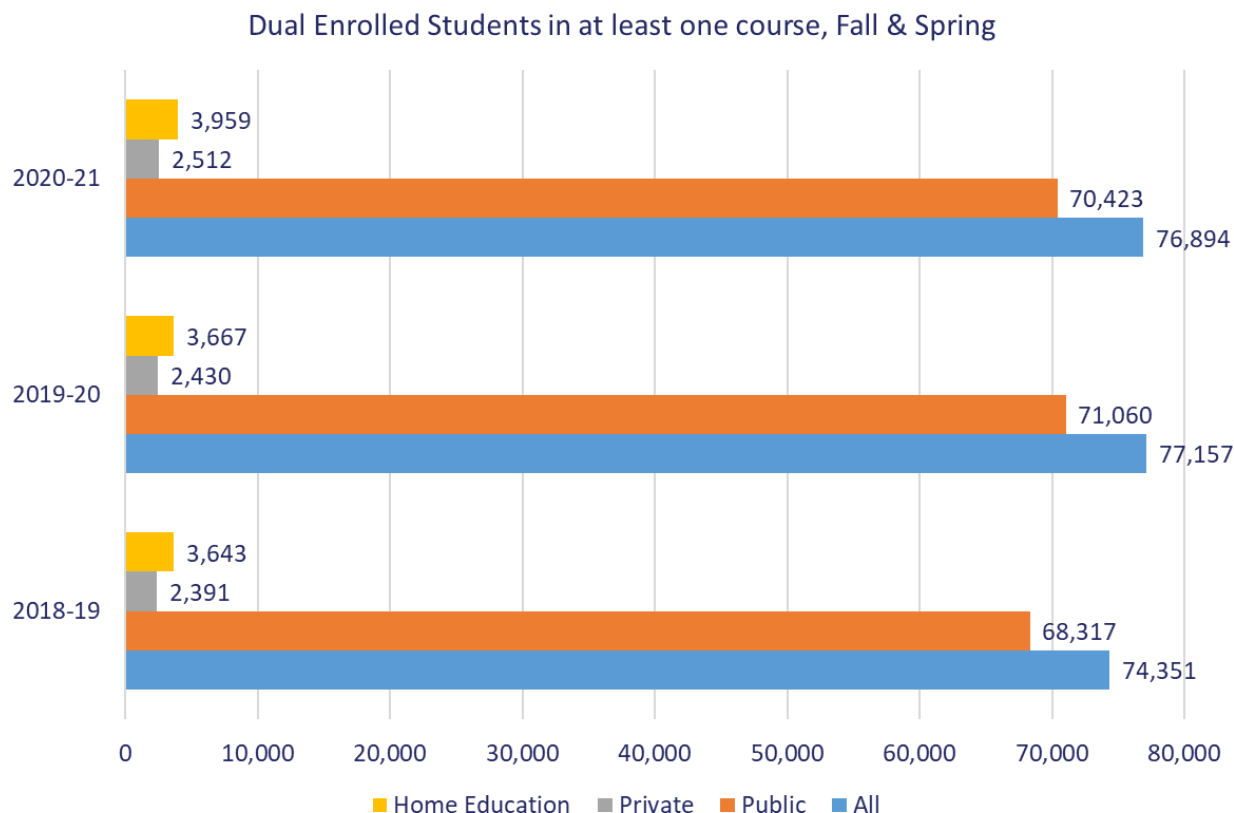

WHAT'S NEXT?

1. Innovation

- In technology and other advances employed in the workplace, and
- In education design and delivery.

2. Continued affordability

3. Even greater access

- To civics and liberal arts foundations, career readiness and entrepreneurship that benefit everyone;
- To the talent businesses need now and in the future;
- To a world-class postsecondary education in every Florida neighborhood; and
- To economic mobility for every Florida family.



FLORIDA DEPARTMENT OF
EDUCATION
fldoe.org

QUESTIONS

WE ARE POLK
POLK STATE COLLEGE



POLK.EDU

DEGREE-SEEKING

13,916

WORKFORCE TRAINING/
CORPORATE COLLEGE

9,000

7

LOCATIONS
Winter Haven
Lakeland
Lake Wales
Bartow

AVERAGE
STUDENT AGE

24.6

PART-TIME
STUDENTS

72%

FULL-TIME
STUDENTS

28%

92%

of 2018-19 Polk State Associate in Arts graduates are employed or continuing their education, making Polk State one of four state colleges that share the highest employment and continuing education rate.

70%

of Polk State graduates remain in Polk County following graduation.





3 COLLEGIATE
HIGH SCHOOLS

WE ARE POLK
POLK STATE COLLEGE

ENROLLMENT

1,588

GRADUATION RATE

100%

60%

of graduates from Polk State's collegiate high schools achieve their Associate in Arts degrees in addition to their high school diplomas.



2+2

TARGETED PATHWAYS



POLK STATE ELITE



WE ARE POLK
POLK STATE COLLEGE

BARTOW, HAINES CITY, RIDGE COMMUNITY HIGH SCHOOLS

- **115** 9th graders have expressed interest in the program.
- **59** 10th graders enrolled in the program and are completing dual enrollment coursework.
- The first cohort of **ELITE baccalaureate students** will be on campus in fall 2022.



WORKFORCE

POLK STATE AEROSPACE

2013

9 STUDENTS

2021

300 STUDENTS

ASSOCIATE IN SCIENCE DEGREES IN:

- Professional Pilot Science
- Aerospace Administration
- Aviation Maintenance

BACHELOR OF SCIENCE IN AEROSPACE SCIENCES
WITH CONCENTRATIONS IN:

- Aerospace Administration
- Professional Pilot

AIRCRAFT DISPATCHER CERTIFICATION

*Polk State Aerospace commercial pilot applications have a **93% first-time pass rate** on the Federal Aviation Administration (FAA) certification exam, exceeding the 80% minimum pass rate.*



*We are Polk.*TM



polk.edu

MDC: Workforce and Economic Engine of Greater Miami



MDC.edu

Madeline Pumariega
President
Miami Dade College

 **Miami Dade
College**

About MDC

Student Profile

120,000 Students Yearly

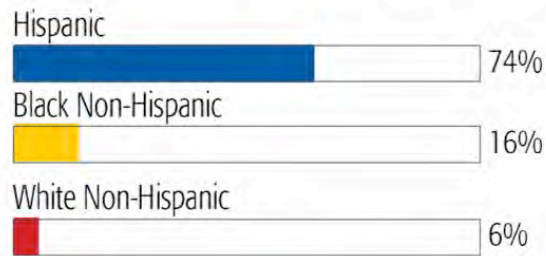

Florida 2+2 Pathways to Success

Florida's higher education system is designed to allow students who wish to earn a bachelor's degree to complete their first two years at a two-year institution such as MDC. This approach to earning a bachelor's degree is commonly referred to as the 2 + 2 system. MDC has formal agreements in place with more than 60 colleges and universities throughout the United States and the world.

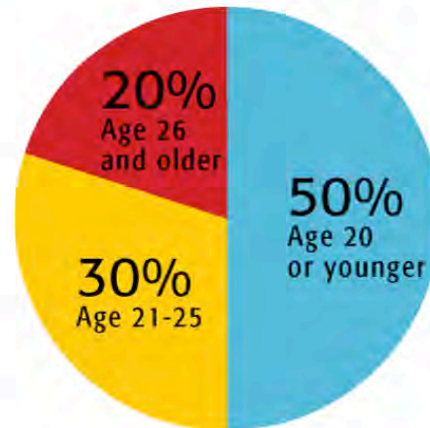

23.1 Average age of associate degree students
29.9 Average age of baccalaureate degree students

Enrollment by Degree Program

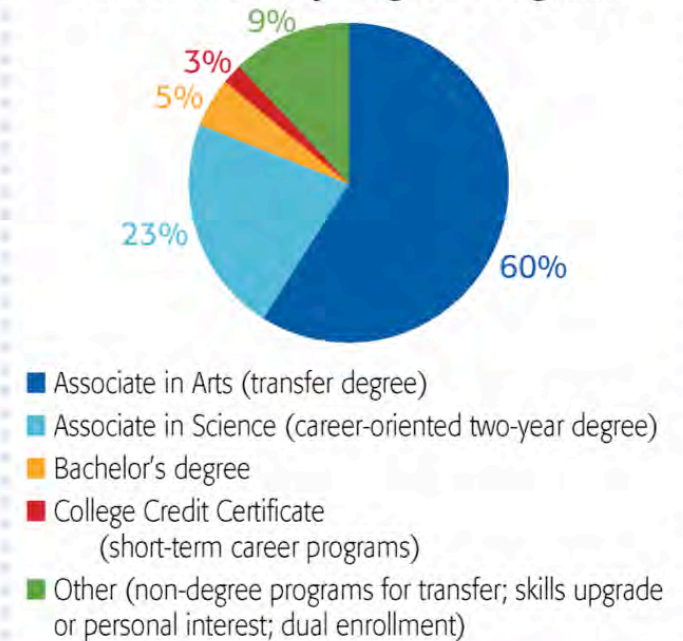

Fueling the Workforce

- **9 out of 10 graduates** stay in Miami-Dade County after completion.
- MDC works with industry to ensure workforce-ready graduates. Much of this work involves aligning curriculum marked for rapid growth in the Miami-Dade Beacon Council's One Community One Goal economic development plan.

These **target industries** have the highest potential for job growth and high wages:

- **Aviation**
- **Banking and Finance**
- **Creative Design**
- **Hospitality and Tourism**
- **Life Sciences and Health Care**
- **Technology**
- **Trade and Logistics**

Employment and Outcomes



79%

Associate in Arts graduates who transferred to Florida colleges and universities to continue their education



96%

Associate in Science degree graduates who found employment (including serving in the Military)



97%

Bachelor's degree graduates who found employment (including serving in the Military)

\$48,960

Average annual earnings of Associate in Science degree graduates

\$56,312

Average annual earnings of Bachelor's degree graduates

Powerful Partnerships

With K-12 and the Community



- Dual Enrollment
- School for Advanced Studies (SAS)
- Career and Technical Education (CTE)

With Industry



AI with Microsoft and IBM

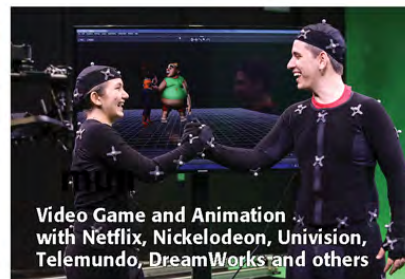

Video Game and Animation
with Netflix, Nickelodeon, Univision,
Telemundo, DreamWorks and others



TESLA



Health Care Programs



NORTHWEST FLORIDA STATE COLLEGE

Dr. Devin Stephenson, President

COLLEGE OVERVIEW



- ~ 50 years advancing community, workforce, and economic development opportunities
- ~ Focused on student success
- ~ Committed to affordability
- ~ \$326 million regional economic impact annually



CAREER EDUCATION

- National Award-Winning Welding Program
- New Career Education Programs:
 - Commercial Driving License
 - Walton Works Training Center
 - Aviation Center of Excellence



CAREER EDUCATION



- New Health Sciences Programs:
 - Physical Therapist Assistant
 - Medical Laboratory Technician
- Expansions Planned:
 - Registered Nurse
 - Nursing Baccalaureate



NORTHWEST
FLORIDA
STATE COLLEGE

FUTURE FOCUS

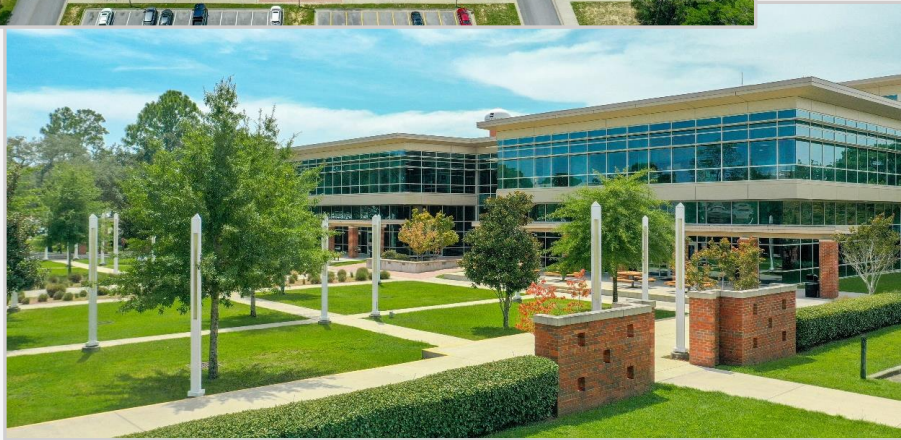

- Expand partnerships
- Meet evolving workforce needs with relevant programming
- Remain flexible, adaptable, and available to change

NORTHWEST
FLORIDA
STATE COLLEGE





Thank You!

NORTHWEST
FLORIDA
STATE COLLEGE



Making an IMPACT

Dr. Tonjua Williams, President

October 12, 2021

ST. PETERSBURG COLLEGE



Accelerated Learning

Enrollment and Success Rates, for Dual Enrollment/Early College/Early Admission/Collegiate High School Programs

	Dual Enrollment (part-time)	Early College (full-time 2- year program)	Early Admission (full-time 1- year program)	St. Petersburg Collegiate High Schools	Dual Enrollment Off-Site
2020-21 Enrollment	4,064	369	162	451	3,137 Public 2,867 Private 270
2020-21 Course Success Rates (C or better)	88%	93%	92%	89%	88%
2019-20 Enrollment	3,846	375	160	382*	2,609 Public 2,330 Private 279
2019-20 Course Success Rates (C or better)	91%	95%	93%	94%	91%
2018-19 Enrollment	3,207	375	160	243*	2,086 Public 1,781 Private 305
2018-19 Course Success Rates (C or better)	92%	95%	96%	94%	93%



ST. PETERSBURG COLLEGE

Workforce Training & Partnerships

• New Workforce Programs 2021

- Lineworker
- Patient Care Technician (w/CNA)
- Phlebotomy Technician
- Solar Power Associate
- Google IT
- MS Cloud+
- Amazon Web Services
- Drone Safety
- NFTE Entrepreneurship Essentials



• Rapid Credentials

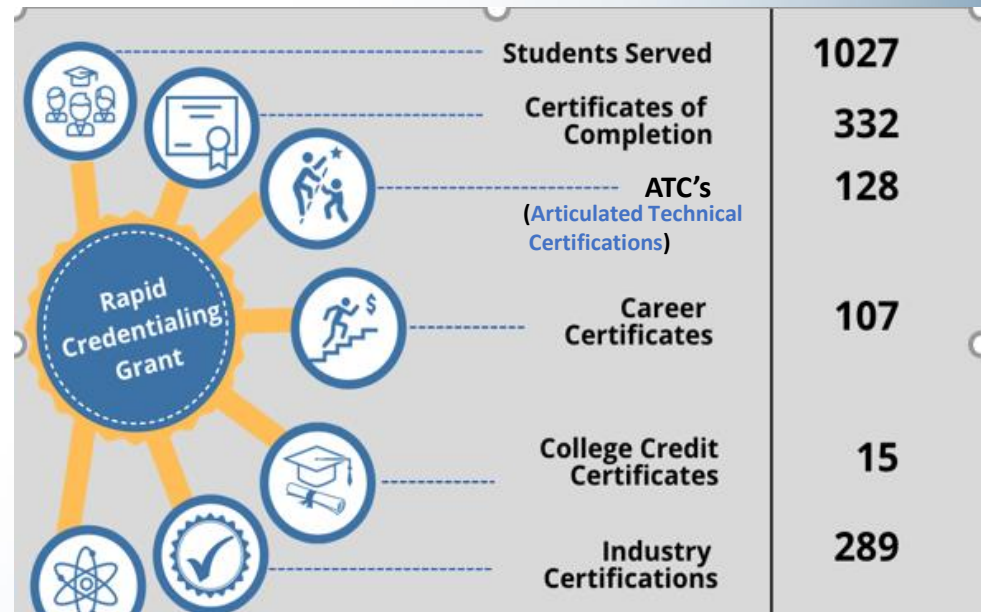

ST. PETERSBURG COLLEGE

Job Placement & Wages

STUDENT EARNINGS

ENTRY LEVEL WAGES

\$39,268

FCS 2018

\$45,280

SPC 2018

\$51,248

SPC 2019

• Employment Rate Goal vs. Current Rate

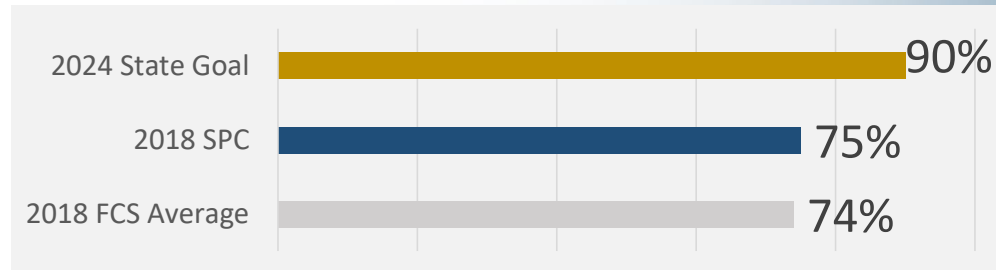

2018-19	Employed	Continuing Education	Employed or Continuing Education
AA	68%	70%	90%
AS	81%	39%	88%
Bachelors	78%	9%	80%

Source: FLDOE FETPIP reports & FLDOE Strategic Plan Measures (most current data)



ST. PETERSBURG COLLEGE

Student Transfers

- 2017-2019 SPC AA Graduates enrolled in a 2+2 Transfer Pathway

2+2 Program	Enrolled at Target SUS	Enrolled at Different Institution	Did not enroll after SPC Graduation
Fuse St. Petersburg	70%	23%	7%
Fuse Tampa	67%	22%	11%
Ignite	20%	70%	10%

Source: National Student Clearinghouse and SPC's Student System

- Overall Transfer Information for 2017-19 Graduates:

70% of all SPC AA graduates transferred to any 4yr program:

- 36% transferred to SUS
- 29% transferred to FCS (mostly to SPC)
- 5% to Other Institutions

30 PATHe
Graduates in
2020-21



ST. PETERSBURG COLLEGE

Questions?





State University System

Marshall M. Criser III, Chancellor
October 12, 2021

www.flbog.edu

#1 Higher Education System



SUS Overview

12
public institutions

430,000+
students

97,000+
degrees awarded

2nd
lowest tuition in
the country



Florida continues to be nationally recognized



**1 of 3 states
with at least
1 institution
in the
Top 5, 20, & 50**



**5 institutions
in the Top
100 public
universities**



**Top Public
Historically
Black College
& University**



**#5 Public
Liberal Arts
Institution**



Board Strategies



Encourage SUS to improve & expand existing local 2+2 programs



Identify key components of effective 2+2 enhancement programs



Regularly monitor critical data points at institution & system level



Outcomes

- **All SUS & FCS institutions** have 2+2 enhancement programs
- All 12 SUS institutions **conducted self-evaluations** of their enhancement programs; update expected spring 2022
- **New metric added to the 2025 Strategic Plan** to monitor the 3-year graduation rate of FCS AA transfer students
- Board office monitors 2+2 programs

COVID-19 University Research Highlights

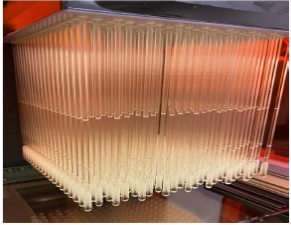

The System has utilized its strengths across disciplines to help the state, country, & world respond to the pandemic

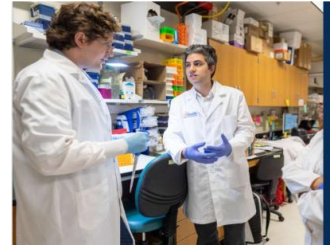

nearly
200

research projects receiving competitive federal awards

+\$45M

federal funds awarded

15

System collaborations on federal COVID-19 research

Examples

- UCF researchers have developed a disinfectant that can continuously kill viruses on a surface for up to 7 days
- UF is studying the Delta variant vaccine breakthrough in Florida (UCF partner)
- FIU is examining COVID-19-related health disparities & enhancing access in underserved populations

SUS universities partner with industries & other entities to conduct research, especially in STEM fields

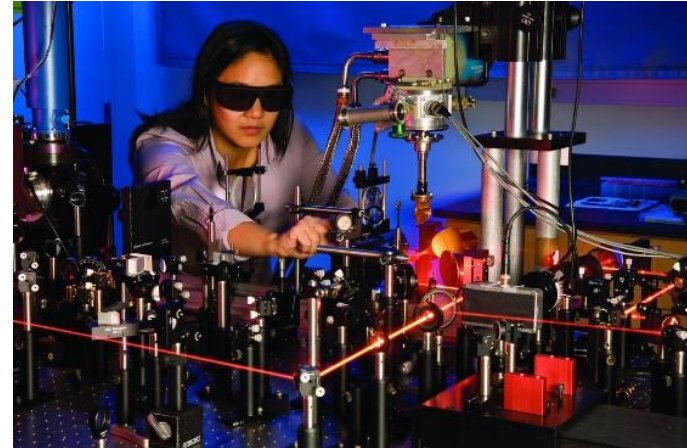

Examples of Industry Partnerships

- Northrup Grumman
- Lockheed Martin
- M4 Engineering
- Solvay/Cytec
- Aerosonic Corporation
- Cascade
- Huntsman/Nanocomp
- Boeing
- Opterus R&D
- AnalySwift
- GE
- Rocco

Enrollment & Degrees Awarded (2020)



Undergraduate Enrollment

280,355
Total Students



3% over the
last 5 years

New FTIC
43,222

Returning FTIC
118,541

FCS AA Transfer
69,326

The # of **returning FTIC students** has increased, due to improved student success initiatives funded by PBF



Degrees Awarded

72,214
Bachelor's Degrees



14%
Last 5 years

24,984
Graduate Degrees



10%
Last 5 years

Job Placement of Baccalaureate Degree Recipients

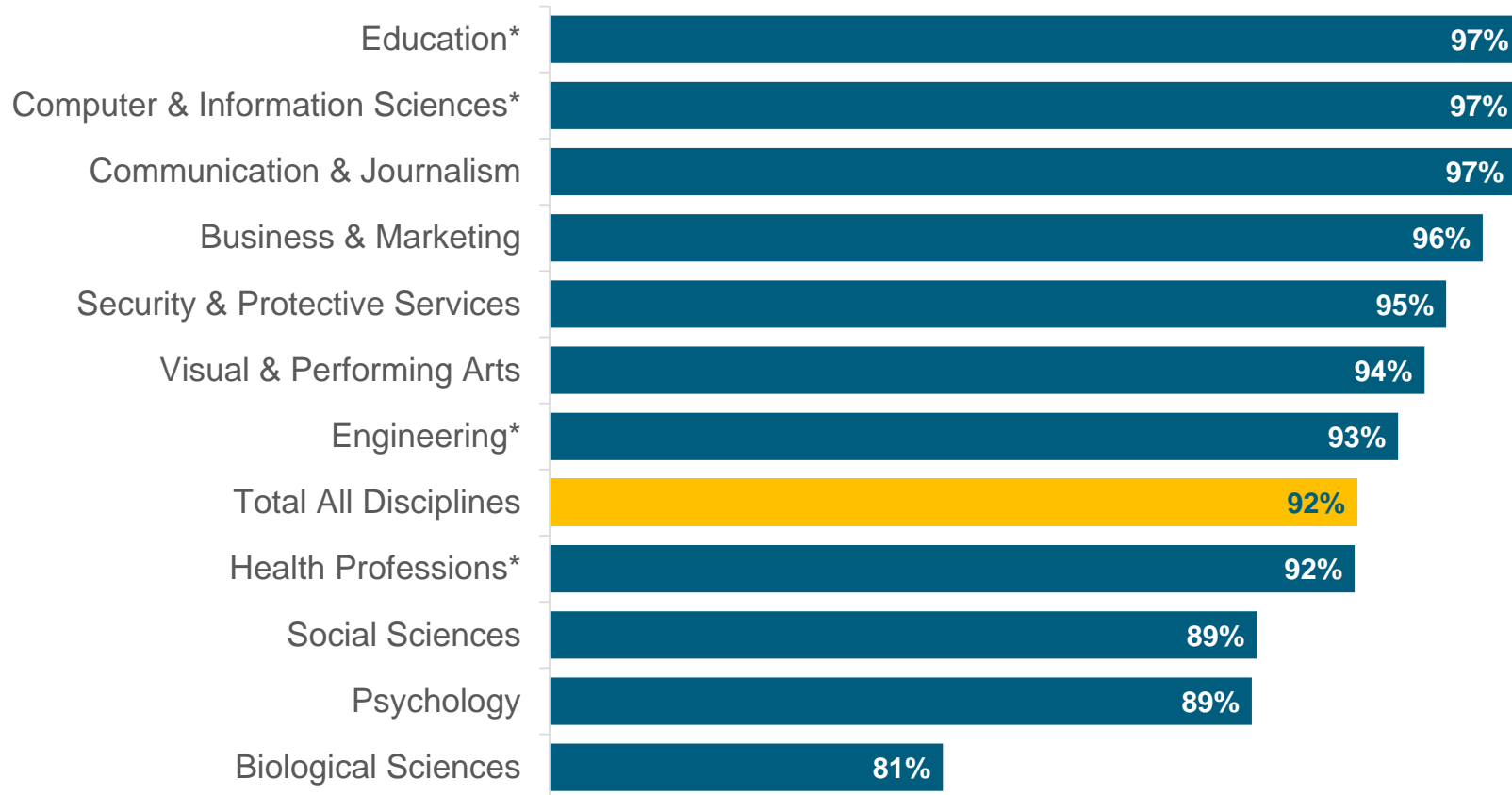

Wages of Baccalaureate Degree Recipients

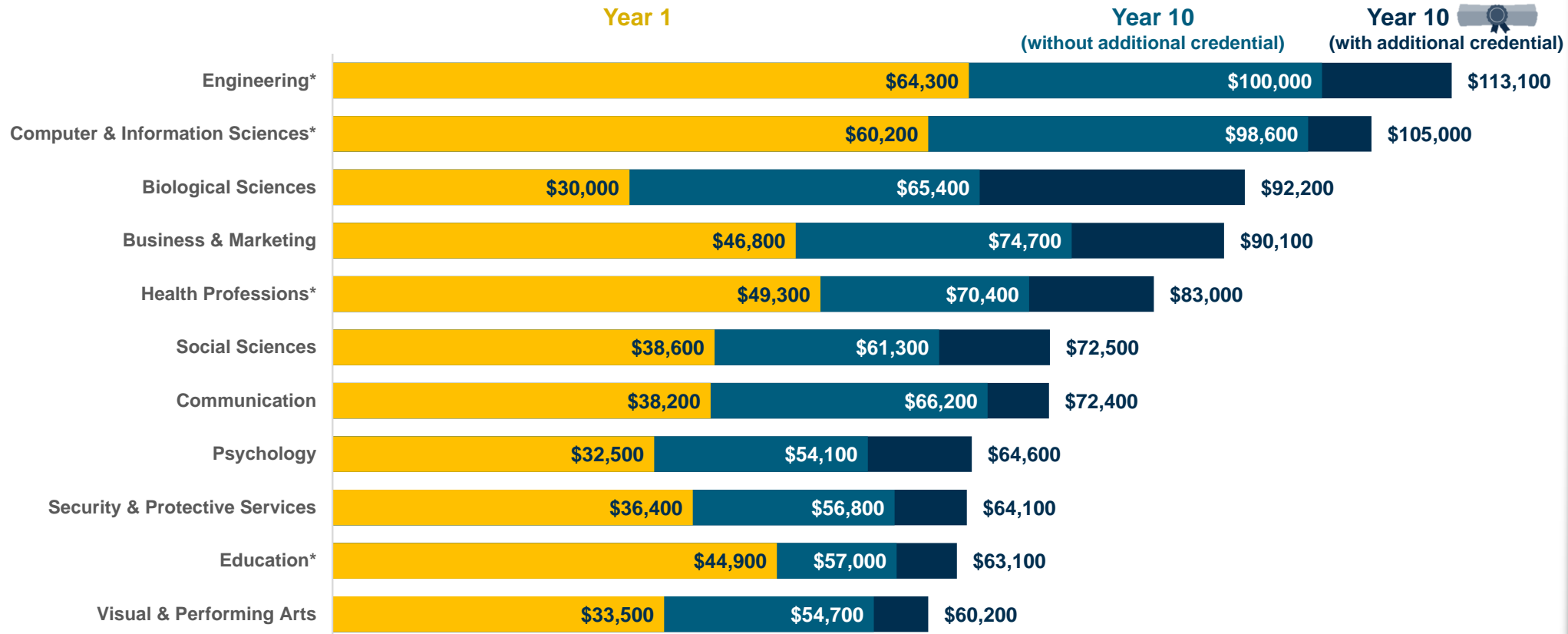



www.flbog.edu



FLORIDA POLYTECHNIC
UNIVERSITY

Senate Education Panel Committee on Higher Education

**Randy K. Avent
12 October 2021**

Major	% Students	% Job Growth ¹	Median Salary ¹
Computer Science	44.46%	22.6%	\$93,606
Mechanical Engineering	21.90%	11.3%	\$83,158
Computer Engineering	12.07%	10.3%	\$96,636
Data Science/Analytics	8.16%	35.5%	\$73,933
Electrical Engineering	6.24%	11.9%	\$90,667
Environmental Engineering	1.08%	7.8%	\$71,988

- **Florida Poly degrees are aligned to the state's workforce needs in high-skill, high-wage technology industries**

¹Projections (2027) from Florida Department of Economic Opportunity

Differentiated Value

- **Intentional focus on Engineering, Computer, and Mathematical Sciences**
- **Provides students with small classes, a high-touch model, and rich co-curricular experiences**
- **University of Distinction in undergraduate engineering education with a focus on keeping high-performing high school students in Florida**
- **Important rankings**
 - Ranked #1 Public College in the South
 - Ranked #53 Best Undergraduate Engineering Program (no Doctorate)
 - Ranked #14 nationally among all universities for Best Student Career Outcomes

Balanced Curriculum

- **Curriculum “tug of war”**
 - Industry wants technology focus for near-term employability
 - Students need theory focus for lifetime employability
- **Traditional engineering courses that focus on LEARNING**
 - Broad curriculum provides foundational knowledge
 - Strong focus on theory and fundamentals
 - Theory reinforced through laboratory-based projects
- **Co-curricular experiences that focus on APPLYING**
 - Internships are required for graduation
 - Senior capstone projects proposed by industry
 - Leadership for professional skill development
 - “Stackable micro-credential” coding pathway

Industry Partnerships

- **Primary focus on Small and Medium Businesses (SMBs)**
- **Enjoy strong industry support of co-curricular experiences**
 - Actively partner with well over 300 companies to provide internships
 - Senior capstone projects provided by 45 companies this year, 82 unique companies since FY19
 - Curriculum advisory board includes 25 companies
- **Our graduates are in high-demand, low-supply fields**
 - LinkedIn data used to track 42% of graduates show 412 different companies, with 92 (22%) hiring multiple graduates
 - Data also shows that 82% of our graduates remain in Florida
- **Trajectory is to grow a “live-work-play” innovation park**
 - Data shows that areas with technical research universities similar to Florida Poly have nearly 400% more GDP growth than those without

IFF Global Innovation Center

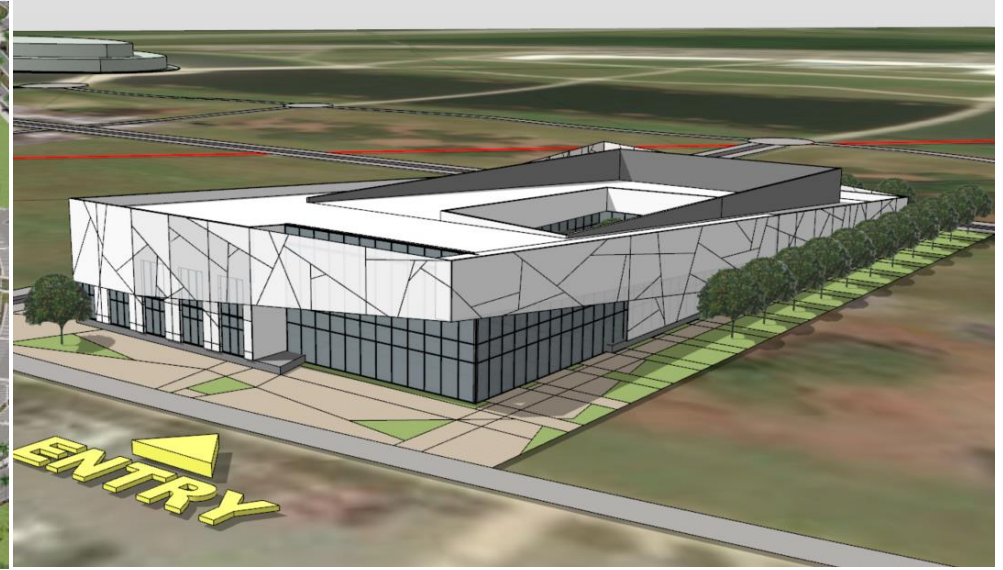

- IFF is a global industry leader in food, beverage, scent, health, biosciences, and sensorial experiences
- Headquartered in NY City with manufacturing facilities in 47 countries
- Partnership centers around capstone projects, internships, careers, and joint research
- Initial focus on microcontroller, agile manufacturing, machine learning and analytics, and virtual reality

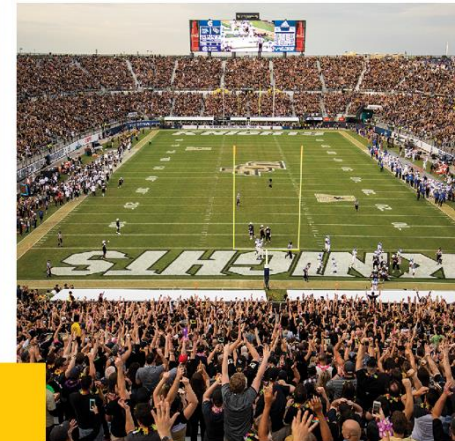
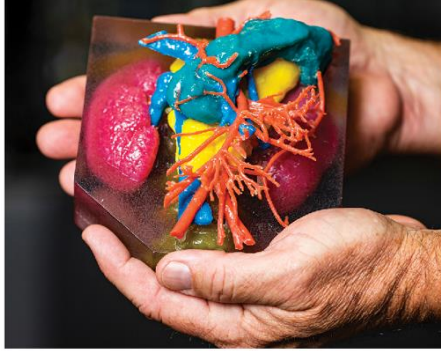

A University *for* the Future

UNIVERSITY OF CENTRAL FLORIDA



Quick Facts

70,730

STUDENTS ENROLLED

FALL 2021

378,806

DEGREES CONFERRED

AS OF AUGUST 2021

1325

AVERAGE SAT

INCOMING 2021 FALL FRESHMEN CLASS

4.25

AVERAGE GPA

INCOMING 2021 FALL FRESHMEN CLASS

46%

MINORITY ENROLLMENT

FALL 2021

35%

PELL-ELIGIBLE

FALL 2021

334,000+

LIVING ALUMNI

FALL 2021

42

AVG. ALUMNI AGE

FALL 2021

#1

**GRADUATE VIDEO GAME DESIGN
PROGRAM IN THE WORLD**

THE PRINCETON REVIEW AND PC GAMER MAGAZINE

#1

**COLLEGIATE CYBERSECURITY
TEAM IN THE COUNTRY**

NATIONAL COLLEGIATE CYBER DEFENSE COMPETITION
SPONSORED BY RAYTHEON, 2021

#2

**FOR HOSPITALITY AND TOURISM
MANAGEMENT IN THE WORLD**

SHANGHAI RANKING

#2

**SOCIAL MOBILITY IMPACT
RANKING FOR PELL SUCCESS**

EDUCATION REFORM NOW

#15

**MOST INNOVATIVE UNIVERSITY
IN THE COUNTRY**

U.S. NEWS & WORLD REPORT

PARTNERSHIPS that advance student outcomes

DirectConnect to UCF

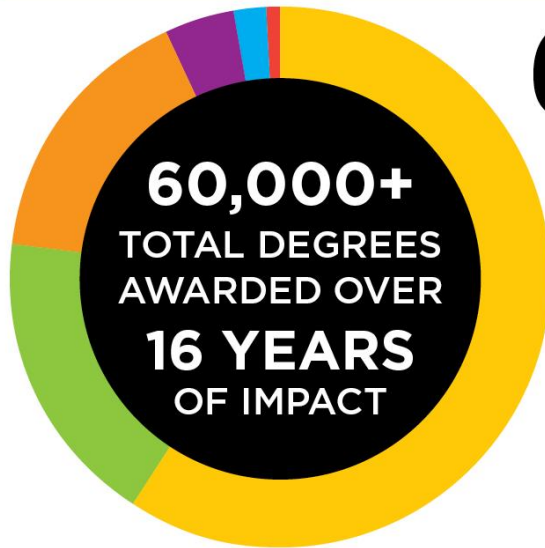

5,000+
DEGREES TO DIRECTCONNECT
STUDENTS ANNUALLY

6 STATE COLLEGE PARTNERS

59%	VALENCIA COLLEGE
18%	SEMINOLE STATE
16%	EASTERN FLORIDA STATE
4%	LAKE SUMTER STATE
2%	DAYTONA STATE
1%	COLLEGE OF CENTRAL FL

MORE THAN
30%
INCOMING STUDENT
POPULATION FROM
DIRECTCONNECT

UCF Downtown



UCF Center for Community Partnership Schools



Florida Consortium of Metropolitan Research Universities



PARTNERSHIPS that solve societal challenges

Lockheed Martin
Cyber Innovation Lab



Siemens
Digital Grid Lab



Townes Institute
Science and Technology
Experimentation Facility



UCF Coastal
The National Center for
Integrated Coastal Research



UCF Institute for Simulation & Training



Future City Initiative at UCF



PARTNERSHIPS that fuel the workforce

#1 SUPPLIER OF GRADUATES TO
U.S. AEROSPACE AND DEFENSE
INDUSTRIES AVIATION WEEK

29% KENNEDY SPACE CENTER
EMPLOYEES ARE UCF GRADS

Sampling of Key Partners Who Advise Academic Leadership



17,000+
DEGREES AWARDED ANNUALLY

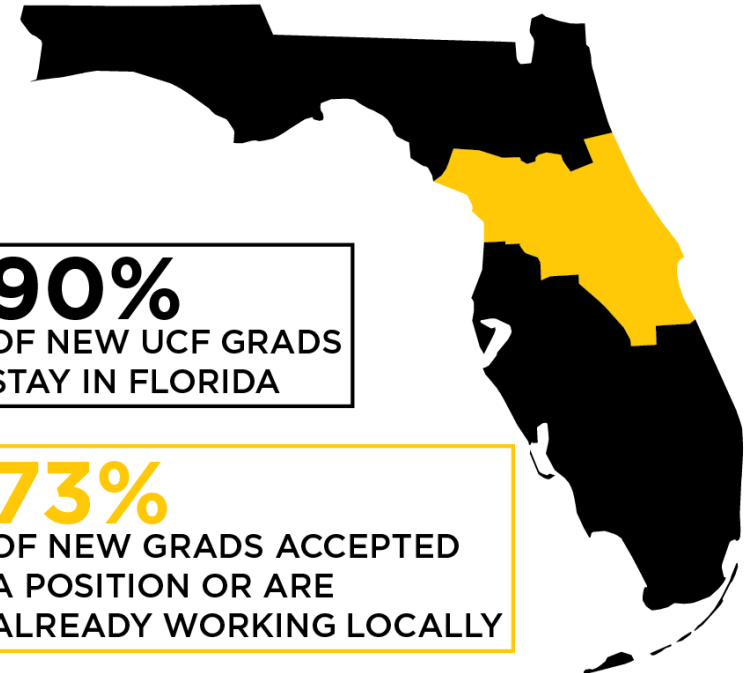

universities of **DISTINCTION**



Impacted Industries

- › Artificial Intelligence
- › Machine Learning
- › Augmented Reality
- › Virtual Reality
- › Mixed Reality
- › Cyber Security
- › Aviation
- › Space Sciences
- › Energy/Power Systems
- › Modeling and Simulation
- › Themed Experiences

Strengthen our partnerships
Build upon our research excellence
Increase our students' success

UCF Powering Up Florida's High Tech Economy

64 Faculty Members	\$13.1 million recurring
16 Support Positions	\$1.3 million recurring
EXCEL/Bridge Investments	\$2 million recurring
Funds for Student Assistants	\$2 million recurring
Lab Equipment Upgrades	\$3 million non-recurring

Total **\$21,422,400**

University of North Florida

Dr. Pamela Chally, Interim President

Uniquely UNF

University of North Florida

By the Numbers

- **Best in the U.S.!**
 - Combination of 2015-19 growth in grad rate, retention rate, freshman class, under-represented freshmen, & Black/African-American freshmen was **#1 in the country**
- **Since 2015:**
 - Raised grad rate by **22+** percentage points
 - Grew freshman cohort size by **62%**
 - Grew traditionally underrepresented freshmen by **174%** and Black/African-American freshmen by **254%**
- **Strongly supportive:** Grad rate for students in need is **a point higher** than non-need students
- **More individualized attention:**
 - Current size: 17,000 students
 - Student-faculty ratio of 19-to-1; average class size of 29
- Went from unranked nationally to **#132 among public universities** in just 3 years

Uniquely **UNF**

UNF Focus on Connecting Students to Jobs

- UNF currently leads the SUS in % of undergraduates employed in Florida within a year post graduation*
- Restructuring & Centralization of Career Services in Alignment with HB1261
 - Major Selection
 - Interview Preparation and Resume
 - Employer Engagement & Partnerships
 - *90% of UNF seniors participate in high-impact practices (e.g., internships, research)*

*Florida Department of Education's "Florida Education & Training Placement Information Program"

Uniquely UNF

UNF Meeting Workforce Needs

New programs in the following to support the workforce needs of the region:

- Business Analytics
- Business Intelligence
- Materials Science & Engineering
- Biomedical Sciences
- Advanced Manufacturing
- Data Science
- Curriculum & Instruction
- Construction Management

Uniquely UNF

UNF Meeting Workforce Needs

Five-year growth in areas of strategic emphasis:

- Computing & engineering enrollment up 25%
- BS in Behavioral Neuroscience majors: from 0 to 108
- Masters in Health Administration majors up 52%
- Doctor of Nursing Practice majors up 28%
- MS in Biology majors up 43%
- BS in Building Construction majors up 56%
- BBA in Marketing majors up 53%
- BBA in Finance majors up 23%
- BAE in Special Education majors up 48%
- BS in Health Science majors up 19%
- BS in (research & experimental) Psychology up 55%

Uniquely UNF

UNF: Cyber Security

- NSF funding UNF research in collaboration with UCF - multi-robot agricultural secure data collection system
- UNF collaborates on 2 NSA grants to develop cyber security curriculum:
 - Assisting minority serving institutions
 - Training military and first-responders transitioning to the cybersecurity workforce
- Annual FBI Cyber Symposium held on campus – UNF IT Services received FBI Director's Community Leadership Award

Uniquely UNF

UNF Solving Problems Through Research

Regionally, Statewide, Globally

Johnson & Johnson

- Global biomedical 3D printing headquarters located on UNF campus
- Supports 3D printing research for all J&J entities
- Partnership led to the creation of:
 - Trumatch - the first commercial 3d printed bone graft cage
 - Ventilator Splitters used in the first COVID Wave crisis
 - All were provided to hospitals at no cost
 - All splitters printed on UNF campus
 - Students engaged throughout process
 - J&J received Global Supply Chain Award

Uniquely UNF

UNF Solving Problems Through Research

- Patent-pending Surfactant-Induced Soil Strengthening compound provides an inexpensive, easily applied, and **environmentally safe method** with potential applications from **construction to dune stabilization**
- Spinoff company is commercializing UNF patented technology that **harnesses ocean energy to generate electricity** for short-term use during disasters or for military applications
- Two sets of chemical showing considerable efficacy at **inhibiting cancer cell growth while leaving healthy cells unharmed**

Uniquely UNF

University of Distinction: UNF MedNexus

Learning

Train the next generation of leaders and address healthcare worker shortages

Leading

Convene thought leaders around critical healthcare issues and research

Innovating

MedTech Innovation Lab to foster creativity and new approaches to healthcare provision through collaboration with Colleges, Universities, healthcare providers, communities and government

Uniquely UNF

University of Distinction: UNF MedNexus

UNF MedNexus Phase I – funded by Florida Legislature

- New state-of-the-art Nursing Simulation Center – Jacksonville
- Additional nursing faculty
- Scholarships
- New teaching facility in Palm Coast for nursing students (with additional support from City of Palm Coast & AdventHealth)
- Creation of UNF MedNexus Med Tech Innovation Lab
 - State of the art spectrometry equipment for early diagnostics research
 - Johns Hopkins Children's Hospital & UNF collaborating on joint appointment to oversee use of equipment
 - Johns Hopkins Children's Hospital, Mayo Clinic & MD Anderson supported funding request as they plan to partner on research

Uniquely UNF

University of Distinction: UNF MedNexus

Academic Partnerships

- Partnerships
 - Florida State College Jacksonville
 - St. Johns River College
 - Daytona State College
- UNF MedNexus Health Honors Direct
- Inter-institutional facility sharing agreement with FSCJ Deerwood
- Pathways from High School
- UNF MedNexus High School Innovation Challenge Nov. 4 – partnership with Flagler County Public Schools & City of Palm Coast

Uniquely UNF

University of Distinction: UNF MedNexus Next Phase

UNF MedNexus Phase II – included in Board of Governors
2022-23 Legislative Budget Request

UNF is requesting approx. \$2.8 million in state support to:

- Increase the number of UNF MedNexus nursing graduates from the UNF Brooks College of Health
- Expansion of 3D biomedical print lab for faculty/student/partner research

Uniquely UNF

An aerial photograph of the Florida Gulf Coast University campus, featuring various academic buildings, green lawns, and a large circular structure in the foreground. The entire image is overlaid with a semi-transparent teal color.

Florida Gulf Coast University

Florida Senate Education Committee

October 12, 2021



FGCU 25 YEARS AND BEYOND

FGCU's long-term commitment is to transform the lives of our students, collaborate to address significant issues and challenges of Southwest Florida and expand the workforce to meet the needs of our fellow citizens

OUR GOAL: To offer degrees that take students where they want to go with the opportunity to stay in Southwest Florida, if they choose.

A photograph of four nurses in an operating room, wearing surgical masks and caps, focused on a patient. In the background, a large monitor displays vital signs: heart rate 81, oxygen saturation 97, blood pressure 120/80, and temperature 35. The entire image has a teal overlay.

BSN, MSN AND DNP GRADUATES
OF FGCU'S SCHOOL OF NURSING
ENJOY A 100 PERCENT
EMPLOYMENT RATE ONCE LICENSED
OR NATIONALLY CERTIFIED.



**ENTREPRENEURSHIP STUDENTS
HAVE LAUNCHED 576 BUSINESSES
SINCE 2016.**

FGCU THE WATER SCHOOL

Florida's Board of Governors has approved an FGCU initiative to pursue a University of Distinction designation as a recognized state and national leader in the area of water, focusing on local issues to address challenges with impacts beyond Florida and serve our community by providing valuable information and education

The Water School is being strategically developed with an interdisciplinary academic focus, and collaborative research emphasis that will attract nationally recognized faculty

FGCU/Arthrex, Inc. Badging and Micro-Credential Pilot Program

An Industry Specific Response





FLORIDA
GULF COAST
UNIVERSITY

fgcu.edu



Many companies use the concept/function of “internship” as a type of temporary worker and/or a semblance of staff augmentation. Arthrex has taken a very different approach – how can interns bring new and different methods of thinking into our organization and use these methods to attack real-world business problems? We thrive on innovation and growth...and new, fresh ways of approaching problems is key to this.

During the Spring of 2021, Markus Getter, a senior from FGCU, was selected as one of our internships. During the six-month internship, we were able to use Arthrex’s access to multiple technical certification programs, whereby Markus was able to receive multiple certifications in Artificial Intelligence, Cloud Infrastructure, and IT Operations Management.

This was truly a “win-win” for all involved and I personally believe it is a critical component to our University system being able to deliver “career ready” candidates to the professional workforce. After completing the internship, we were able to bring Markus on board our world-class team!

William (Bill) Huber

Sr. Manager, IT - Global Infrastructure Platforms



As a CIS Major, I have found the knowledge of both technology and business to be foundational to the start of my IT career. The design of FGCU’s CIS curriculum prepared me by showing various aspects of IT through a business-minded perspective.

During my Senior year at FGCU, I was given the opportunity to work alongside many knowledgeable and experienced professionals through an internship with Arthrex. My passion for IT was solidified through this internship, which allowed me to expand upon many of the same concepts that I have learned during my time as a student at FGCU. Strong partnerships between businesses and education have allowed students, like myself, to gain real-world experience that may not otherwise be available.

I have continued to grow my knowledge of business and IT with Arthrex as I work to finish the final semester of my undergraduate degree at FGCU. I am thankful to both FGCU and Arthrex for the investments they have made in my future with persistent efforts to improve education and opportunity for all students throughout these challenging years.

Markus Getter
FGCU '21